

LOCALE COMMERCIALE

PIANO TERRA

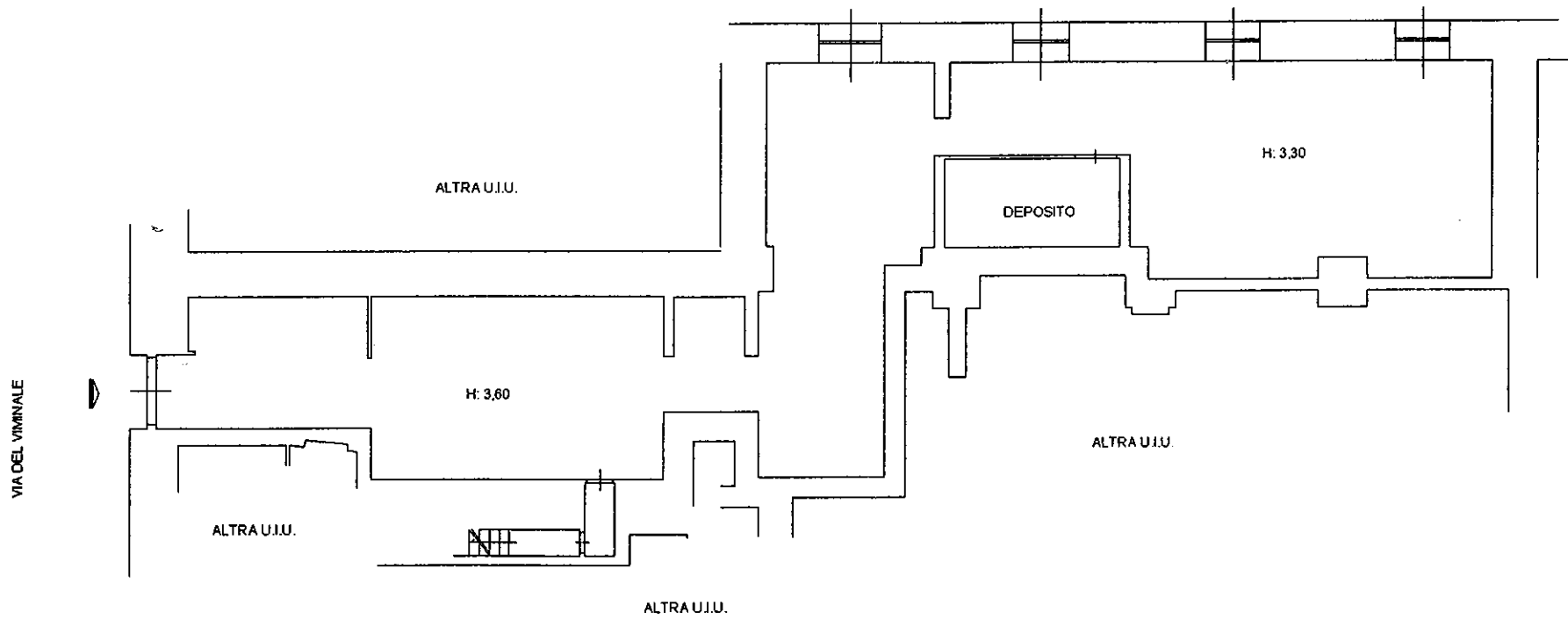

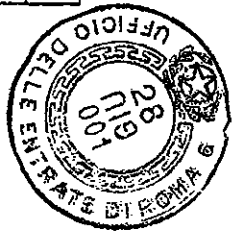
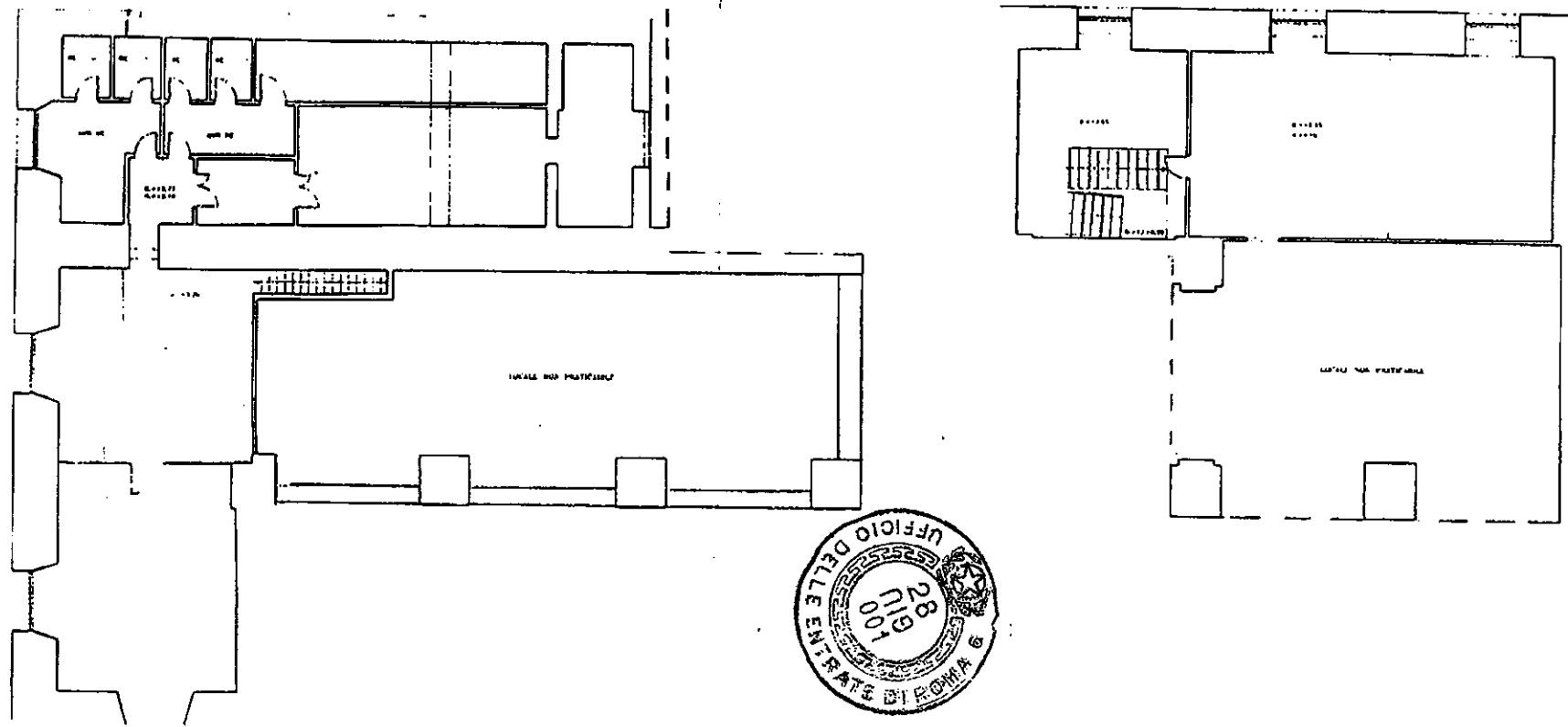

ISTITUTO ROMANO SAN MICHELE	
"IL CLEMENTINO"	Via del Viminale n. 1/b - ROMA
P. PRIMO	SCALA 1/200

IL SEGRETARIO GENERALE
(*Dott. Alessandro Ridolfi*)



IL PRESIDENTE
(*Dott. Marco Buttarelli*)

Handwritten signature or initials.

rep. 6030
ESEDRA GESTIONI AIR FERCHIERE s.r.l. € 68.935.27